

**AERODROME GROUND
MOVEMENT CHART - ICAO**

APRONS ELEV 33'

TWR	118.100	APRON	131.600
GMC	118.800	ATIS	120.175

RIGA

NOTES
1. TWYs: K, L, M and Remote Apron Z3 - daylight operation only.

ELEVATIONS AND HEIGHTS IN FEET
DISTANCES IN METRES

VAR 7°E (2012)
ANNUAL RATE
OF CHANGE
0.12"E

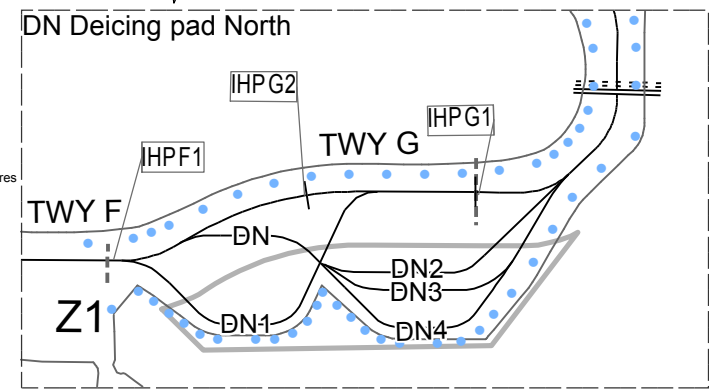
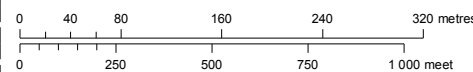
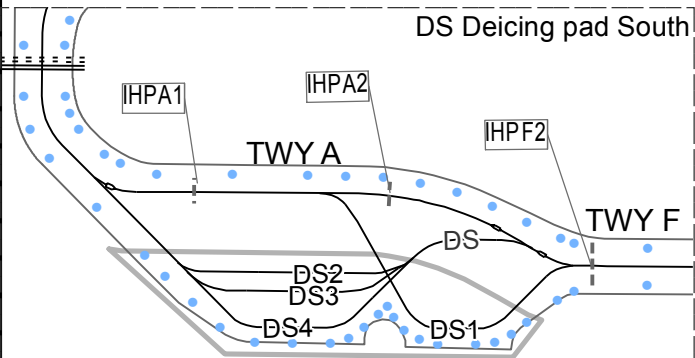
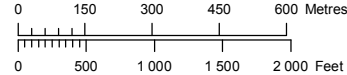
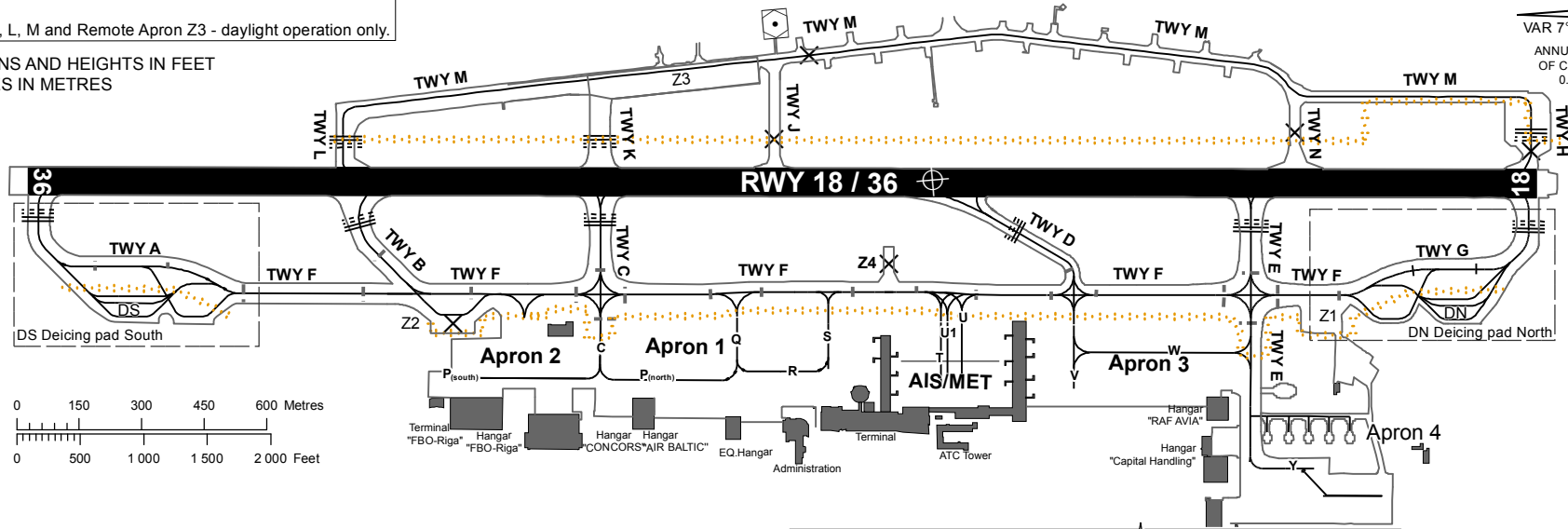

Changes: chart layout changed.

- Z1 - Isolated parking area CONC (available in emergencies)
- Z2 - Unused (CLSD)
- Z3 - Remote Apron (Engine test area, long term parking, military parking) CONC
- Z4 - CLSD
- DN - Deicing pad North
- DN1 - CONC PCN 56/R/C/W/T
- DN2-4 - CONC PCN 77/R/C/W/T
- DS - Deicing pad South
- DS1 - CONC PCN 56/R/C/W/T
- DS2-4 - CONC PCN 77/R/C/W/T

TWY	WIDTH	SURFACE	BEARING STRENGTH
A, E	23m	ASPH	PCN 89/F/C/X/T
B, K	23m	CONC+ASPH	PCN 84/F/A/W/T
C	23m	CONC+ASPH	PCN 89/F/C/W/T
D	18m	ASPH	PCN 50/F/C/X/T
F	23m	CONC+ASPH	PCN 64/F/A/W/T
G	23m	CONC+ASPH	PCN 100/F/C/X/T
J, N, H	18m	CONC	closed
L, M	18m	CONC	PCN 50/R/B/W/U

C, P, Q, R, S, T, U, U1, V, W, Y - Taxilanes
REMARK:
The rapid-exit TWY D is designed for Code C (max.wingspan 36m) or smaller ACFT.

LEGEND
Taxiway edge light
Pavement boundary
Deicing pad boundary

INTENTIONALLY LEFT BLANK